

C.I.P.

375 Rem. Ultra Mag.

Country of Origin: US

TAB.	I
Date	02-01-22
Revision	07-06-20

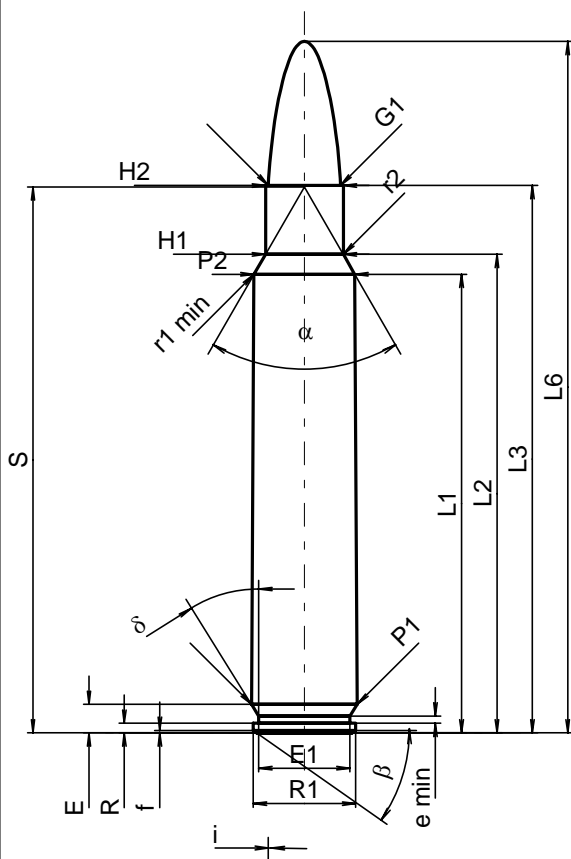

CARTRIDGE MAXI

Lengths

L1 ¹⁾	=	60.64	-0.20
L2 ¹⁾	=	63.28	-0.20
L3 ¹⁾	=	72.39	
L4	=		
L5	=		
L6	=	91.44	

Case Head

R	=	1.27
R1	=	13.56
R3	=	
E	=	3.75
E1	=	12.07
e min	=	0.94
delta	=	32°
f	=	0.31
beta	=	35°

Powder Chamber

P1	=	13.99	
P2 ^{1)*}	=	13.33	-0.20

Junction Cone

alpha*	=	60°
S*	=	72.18
r1 min	=	0.76
r2	=	3.18

Collar

H1*	=	10.29
H2 ¹⁾	=	10.29

Projectile

G1 ¹⁾	=	9.55
G2	=	
F	=	
L3+G ¹⁾	=	84.38

Pressures (Energies)

Method Transducer

Pmax	=	4400 bar
PK	=	5060 bar
PE	=	5500 bar
M	=	25.00
EE	=	7350 Joule

Miscellaneous Dimensions

Fe ¹⁾	=	0.10
delta L	=	0.10

CHAMBER MINI

Lengths

L1	=	60.51
L2	=	63.13
L3 ¹⁾	=	72.64

Breech

R	=	
R1	=	14.05
R2	=	
R3	=	
r	=	

Powder Chamber

E	=	3.75
P1 ¹⁾	=	14.02
P2*	=	13.36

Junction Cone

alpha ^{1)*}	=	60°
S*	=	72.08
r1 max	=	0.76
r2	=	3.18

Collar

H1*	=	10.34
H2 ¹⁾	=	10.31

Commencement of Rifling

G1 ^{1)*}	=	9.55
G ¹⁾	=	11.99
alpha1	=	90°
h	=	0.38
s*	=	4.83
i ^{1)*}	=	1°
w	=	

Barrel

F ^{1)*}	=	9.30
Z ¹⁾	=	9.55

Grooves

b	=	2.92
N	=	6
u	=	304.80
Q	=	70.16 mm ²

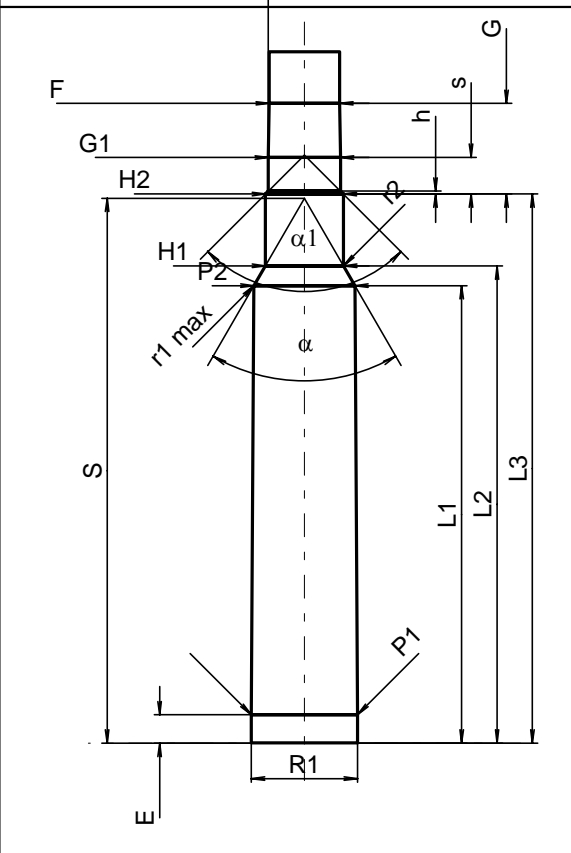

Scale 1:1

Dimensions in << mm >>
Dimensions and Tolerances for Proof Barrels
see Appendix CR 1.

Notes: 1) Check for safety reasons
* Basic dimensions